

# Protector® Storage Cabinets, Base Stands & Fume Hood Accessories





Complete your installation of a Labconco fume hood or enclosure with a base and work surface.  
Add accessories for on-site customization of your laboratory hood.

## Table of Contents

Storage Cabinets & Base Stands Selection Guide	1	ADA Base Stand	9
Protector® Acid Storage Cabinets	2	Telescoping Base Stands	10
Protector® Solvent Storage Cabinets	4	Electric & Manual Hydraulic Lift Base Stands	12
Protector® Standard Storage Cabinets	6	Work Surfaces Selection Guide	14
Protector® Vacuum Pump Storage Cabinets	8	SpillStopper™ & Flat Work Surfaces	15
		Deck-Mounted Accessories	20
		Service Fixture Kits	21
		Fume Hood Accessories	22

**LABCONCO**®

# Protector® Storage Cabinets & Base Stands

## Selection Guide

Mix and match so their total width equals the width of the Labconco fume hood or enclosure they support.\*

### Storage Cabinets

Width/Description	ACID			SOLVENT		
	Dual Doors	Right Hinge	Left Hinge	Dual Doors	Right Hinge	Left Hinge
48"	9901000	—	—	9902000	—	—
36"	9901100	—	—	9902100	—	—
30"	9901200	—	—	9902200	—	—
24"	—	9901300	9901500	—	9902300	9902400
18"	—	9901400	9901600	—	—	—
48" with self-closing doors	—	—	—	9903000	—	—
36" with self-closing doors	—	—	—	9903100	—	—
30" with self-closing doors	—	—	—	9903200	—	—
24" with self-closing doors	—	—	—	—	9903300	9903400
48" ADA**	9905600	—	—	9906600	—	—
36" ADA	9905500	—	—	9906500	—	—
30" ADA	9905400	—	—	9906400	—	—
24" ADA	—	9905000	9905200	—	9906000	9906100
24" ADA with self-closing doors	—	—	—	—	9906200	9906300
18" ADA	—	9905100	9905300	—	—	—

Width/Description	STANDARD			VACUUM PUMP		
	Dual Doors	Right Hinge	Left Hinge	Dual Doors	Right Hinge	Left Hinge
48"	9900000	—	—	—	—	—
36"	9900100	—	—	—	—	—
30"	9900200	—	—	—	—	—
24"	—	9900300	9900600	—	9907200	9907300
18"	—	9900400	9900700	—	9907000	9907100
12"	—	9900500	9900800	—	—	—
48" ADA	9904800	—	—	—	—	—
36" ADA	9904700	—	—	—	—	—
30" ADA	9904600	—	—	—	—	—
24" ADA	—	9904000	—	—	—	—
18" ADA	—	9904100	—	—	—	—
12" ADA	—	9904200	9904500	—	—	—

### Base Stands

Width	TELESCOPING ♿		HYDRAULIC LIFT ♿			ADA ♿
	Fixed Feet	Casters	Electric: 115V, 60 Hz	Electric: 230V, 50 Hz†	Manual	
24"	3746700	3746710	—	—	—	—
36"	3746701	3746711	3780300	3780303	3780400	—
48"	3746702	3746712	3780301	3780304	3780401	9938600
60"	3746703	3746713	—	—	—	—
72"	3746704	3746714	3780302	3780305	3780402	—

\*Basic Laboratory Hoods are not as wide or as deep as the base cabinets, stands and work surfaces that support them.

\*\*Americans with Disabilities Act

†International electrical configuration

♿Stand height meets ADA Standards.

# Protector® Acid Storage Cabinets

## Features & Dimensional Data



### All models feature:

- Used to safely store acids and other corrosive liquids
- Support all Labconco benchtop fume hoods
- Support loads up to 800 lbs.
- Durable powder-coated steel exterior with corrosion-resistant polyethylene-lined interior
- Glacier white exterior complements laboratory casework and Labconco fume hoods
- Manual-closing, non-locking door(s)
- Include polyethylene liner tray, leveling feet and one 8" filler panel to increase cabinet depth to 30". **⚠WARNING: Cancer - P65Warnings.ca.gov (California only)**
- Include two rear cutouts for venting cabinet into a fume hood

### Option includes:

- Lower height (31.5" to 32.5") that meets ADA Standards

### Optional accessories include:

- Vent Kits. See page 3
- Interior Shelf Kits. See page 3
- Additional Filler Panels. See page 3

### All models require (not included):

- Work surface. See pages 14-19

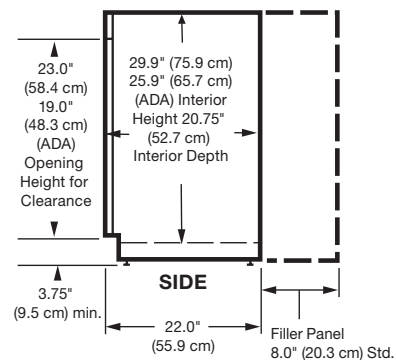
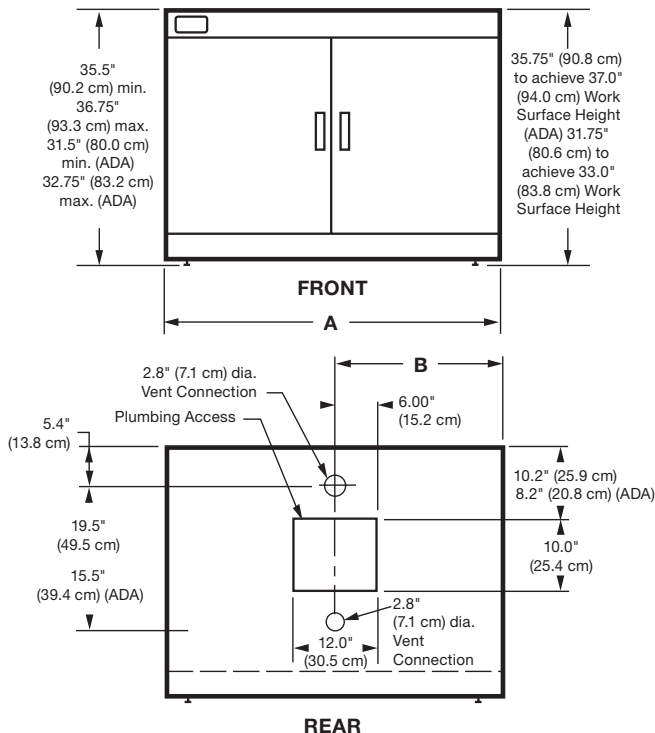

Model(s)	A	B
48" & 48" ADA	48.0" (121.9 cm)	24.0" (61.0 cm)
36" & 36" ADA	36.0" (91.4 cm)	18.0" (45.7 cm)
30" & 30" ADA	30.0" (76.2 cm)	15.0" (38.1 cm)
24" & 24" ADA	24.0" (61.0 cm)	12.0" (30.5 cm)
18" & 18" ADA	18.0" (45.7 cm)	9.0" (22.9 cm)

# Protector® Acid Storage Cabinets

## Ordering Information & Accessories



Catalog Number	Dimensions (w x d x h)	Depth With Filler Panel	Door(s)	Shipping Weight	ADA 
9901000	48.0" x 22.0" x 35.5" to 36.75" (121.9 x 55.9 x 90.2 to 93.3 cm)	30.0" (76.2 cm)	Dual	170 lbs. (77 kg)	
9901100	36.0" x 22.0" x 35.5" to 36.75" (91.4 x 55.9 x 90.2 to 93.3 cm)	30.0" (76.2 cm)	Dual	155 lbs. (70 kg)	
9901200	30.0" x 22.0" x 35.5" to 36.75" (76.2 x 55.9 x 90.2 to 93.3 cm)	30.0" (76.2 cm)	Dual	145 lbs. (66 kg)	
9901300	24.0" x 22.0" x 35.5" to 36.75" (61.0 x 55.9 x 90.2 to 93.3 cm)	30.0" (76.2 cm)	Single Right Hinge	110 lbs. (50 kg)	
9901400	18.0" x 22.0" x 35.5" to 36.75" (45.7 x 55.9 x 90.2 to 93.3 cm)	30.0" (76.2 cm)	Single Right Hinge	100 lbs. (45 kg)	
9901500	24.0" x 22.0" x 35.5" to 36.75" (61.0 x 55.9 x 90.2 to 93.3 cm)	30.0" (76.2 cm)	Single Left Hinge	110 lbs. (50 kg)	
9901600	18.0" x 22.0" x 35.5" to 36.75" (45.7 x 55.9 x 90.2 to 93.3 cm)	30.0" (76.2 cm)	Single Left Hinge	100 lbs. (45 kg)	
9905000	24.0" x 22.0" x 31.5" to 32.75" (61.0 x 55.9 x 80.0 to 83.2 cm)	30.0" (76.2 cm)	Single Right Hinge	100 lbs. (45 kg)	•
9905100	18.0" x 22.0" x 31.5" to 32.75" (45.7 x 55.9 x 80.0 to 83.2 cm)	30.0" (76.2 cm)	Single Right Hinge	90 lbs. (41 kg)	•
9905200	24.0" x 22.0" x 31.5" to 32.75" (61.0 x 55.9 x 80.0 to 83.2 cm)	30.0" (76.2 cm)	Single Left Hinge	100 lbs. (45 kg)	•
9905300	18.0" x 22.0" x 31.5" to 32.75" (45.7 x 55.9 x 80.0 to 83.2 cm)	30.0" (76.2 cm)	Single Left Hinge	90 lbs. (41 kg)	•
9905600	48.0" x 22.0" x 31.5" to 32.75" (121.9 x 55.9 x 80.0 to 83.2 cm)	30.0" (76.2 cm)	Dual	170 lbs. (77 kg)	•
9905500	36.0" x 22.0" x 31.5" to 32.75" (91.4 x 55.9 x 80.0 to 83.2 cm)	30.0" (76.2 cm)	Dual	155 lbs. (70 kg)	•
9905400	30.0" x 22.0" x 31.5" to 32.75" (76.2 x 55.9 x 80.0 to 83.2 cm)	30.0" (76.2 cm)	Dual	145 lbs. (66 kg)	•

**Vent Kits.** For venting cabinet through work surface and into hood. Plastic vent tube assembly (2" dia. threaded connection locknut, flexible tubing and vent extension). Kit 3591102 includes two tube assemblies plus tee connector for venting two side-by-side cabinets supporting a PVC Acid Digestion hood.

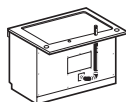

**1589700—Acid Cabinet Vent Hole Plug.** For plugging the ventilation hole if you are unable to vent the acid cabinet into a fume hood. Two required. Shipping weight 1.0 lb. (0.5 kg)

**Filler Panels.** One 8" panel is included with each storage cabinet to extend depth to 30" and enclose the utility chase behind the cabinet. Cabinets supporting hoods with external depths greater than 31.7" require deeper filler panels.

Catalog Number	For Use With Protector Hood	Shipping Weight
3591100	Benchtop Premier, XL, XStream	5.0 lbs. (2.0 kg)
3591101	PVC, supported by one cabinet	5.0 lbs. (2.0 kg)
3591102	PVC, supported by two cabinets	10 lbs. (5 kg)

**Interior Shelf Kits.** Include acid-resistant shelf, supports and mounting hardware. **⚠WARNING:** Cancer - P65Warnings.ca.gov (California only)

Catalog Number	For Cabinet Width	Shipping Weight
9919000	48"	15 lbs. (7 kg)
9919001	36"	12 lbs. (5 kg)
9919002	30"	10 lbs. (5 kg)
9919003	24"	8.0 lbs. (4.0 kg)
9919004	18"	7.0 lbs. (3.0 kg)

Catalog Number	Description	Shipping Weight
9920306	Filler Panel, 8" deep	10 lbs. (5 kg)
9920310	Filler Panel, 14" deep	13 lbs. (6 kg)
9920312	Filler Panel, 20" deep	15 lbs. (7 kg)
9920301	Filler Panel, 15.5" deep	13 lbs. (6 kg)
9920307	ADA Filler Panel, 8" deep	10 lbs. (5 kg)
9920311	ADA Filler Panel, 14" deep	12 lbs. (5 kg)
9920313	ADA Filler Panel, 20" deep	14 lbs. (6 kg)
9920304	ADA Filler Panel, 15.5" deep	12 lbs. (5 kg)

⚠ Cabinet height meets ADA Standards.

# Protector® Solvent Storage Cabinets

## Features & Dimensional Data



### All models feature:

- Used to safely store solvents and other flammable liquids
- Support all Labconco benchtop fume hoods
- Support loads up to 800 lbs.
- Durable dual wall powder-coated steel construction with 1.5" air gap
- Glacier white exterior complements laboratory casework and Labconco fume hoods
- Key lock included. Doors are manual-closing or self-closing/self-latching with sequencing mechanism. Self-closing door(s) shut automatically when temperature reaches 165° F (74° C)
- Include powder-coated steel interior shelf with five height settings, two rear vent connections with flame arrestors and closure plugs, leveling feet and one 8" filler panel to increase cabinet depth to 30"

### Models conform to the following standards:

- National Fire Protection Association (NFPA) 30 Flammable and Combustible Liquids Code Specifications

### Option includes:

- Lower height (31.5" to 32.5") that meets ADA Standards

### Optional accessories include:

- Solvent Vent Kit. See page 5
- Additional Filler Panels. See page 3

### All models require (not included):

- Work surface. See pages 14-19

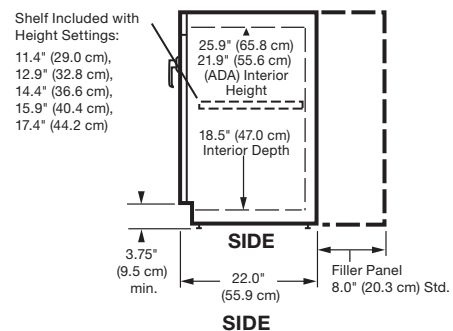
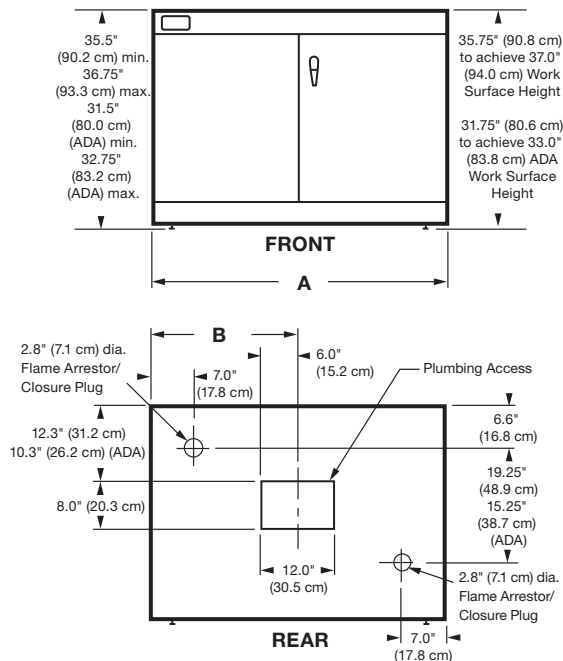

Model(s)	A	B
48" & 48" ADA	48.0" (121.9 cm)	24.0" (61.0 cm)
36" & 36" ADA	36.0" (91.4 cm)	18.0" (45.7 cm)
30" & 30" ADA	30.0" (76.2 cm)	15.0" (38.1 cm)
24" & 24" ADA	24.0" (61.0 cm)	12.0" (30.5 cm)

# Protector® Solvent Storage Cabinets

## Ordering Information & Accessories



Catalog Number	Dimensions (w x d x h)	Depth With Filler Panel	Door(s)	Gallon Capacity	Shipping Weight	ADA
990200*	48.0" x 22.0" x 35.5" to 36.75" (121.9 x 55.9 x 90.2 to 93.3 cm)	30.0" (76.2 cm)	Dual Manual Closing	45	250 lbs. (113 kg)	
990210*	36.0" x 22.0" x 35.5" to 36.75" (91.4 x 55.9 x 90.2 to 93.3 cm)	30.0" (76.2 cm)	Dual Manual Closing	30	205 lbs. (93 kg)	
990220*	30.0" x 22.0" x 35.5" to 36.75" (76.2 x 55.9 x 90.2 to 93.3 cm)	30.0" (76.2 cm)	Dual Manual Closing	25	195 lbs. (88 kg)	
9902300	24.0" x 22.0" x 35.5" to 36.75" (61.0 x 55.9 x 90.2 to 93.3 cm)	30.0" (76.2 cm)	Single, Right Hinge Manual Closing	20	165 lbs. (75 kg)	
9902400	24.0" x 22.0" x 35.5" to 36.75" (45.7 x 55.9 x 90.2 to 93.3 cm)	30.0" (76.2 cm)	Single, Left Hinge Manual Closing	20	165 lbs. (75 kg)	
9906600	48.0" x 22.0" x 31.5" to 32.75" (121.9 x 55.9 x 80.0 to 83.2 cm)	30.0" (76.2 cm)	Dual Manual Closing	35	245 lbs. (111 kg)	•
9906500	36.0" x 22.0" x 31.5" to 32.75" (91.4 x 55.9 x 80.0 to 83.2 cm)	30.0" (76.2 cm)	Dual Manual Closing	25	200 lbs. (91 kg)	•
9906400	30.0" x 22.0" x 31.5" to 32.75" (76.2 x 55.9 x 80.0 to 83.2 cm)	30.0" (76.2 cm)	Dual Manual Closing	20	190 lbs. (86 kg)	•
9906000	24.0" x 22.0" x 31.5" to 32.75" (61.0 x 55.9 x 80.0 to 83.2 cm)	30.0" (76.2 cm)	Single, Right Hinge Manual Closing	15	150 lbs. (68 kg)	•
9906100	24.0" x 22.0" x 31.5" to 32.75" (61.0 x 55.9 x 80.0 to 83.2 cm)	30.0" (76.2 cm)	Single, Left Hinge Manual Closing	15	150 lbs. (68 kg)	•
9903000*	48.0" x 22.0" x 35.5" to 36.75" (121.9 x 55.9 x 90.2 to 93.3 cm)	30.0" (76.2 cm)	Dual Self-Closing/ Latching	45	280 lbs. (127 kg)	
9903100*	36.0" x 22.0" x 35.5" to 36.75" (91.4 x 55.9 x 90.2 to 93.3 cm)	30.0" (76.2 cm)	Dual Self-Closing/ Latching	30	225 lbs. (102 kg)	
9903200*	30.0" x 22.0" x 35.5" to 36.75" (76.2 x 55.9 x 90.2 to 93.3 cm)	30.0" (76.2 cm)	Dual Self-Closing/ Latching	25	215 lbs. (98 kg)	
9903300	24.0" x 22.0" x 35.5" to 36.75" (61.0 x 55.9 x 90.2 to 93.3 cm)	30.0" (76.2 cm)	Single, Right Hinge Self-Closing/ Latching	20	165 lbs. (75 kg)	
9903400	24.0" x 22.0" x 35.5" to 36.75" (61.0 x 55.9 x 90.2 to 93.3 cm)	30.0" (76.2 cm)	Single, Left Hinge Self-Closing/ Latching	20	165 lbs. (75 kg)	
9906200	24.0" x 22.0" x 31.5" to 32.75" (61.0 x 55.9 x 80.0 to 83.2 cm)	30.0" (76.2 cm)	Single, Right Hinge Self-Closing/ Latching	15	160 lbs. (73 kg)	•
9906300	24.0" x 22.0" x 31.5" to 32.75" (61.0 x 55.9 x 80.0 to 83.2 cm)	30.0" (76.2 cm)	Single, Left Hinge Self-Closing/ Latching	15	160 lbs. (73 kg)	•

**9910000—Solvent Vent Kit.** Includes 1.5" dia. x 17' long metal flexible hose, two hose clamps and 2" NPT x 1.5" slip-fit outlet adapter. Not available in Canada. Shipping weight 5.0 lbs. (2.3 kg)

Hose must be connected to negatively pressured ductwork above fume hood

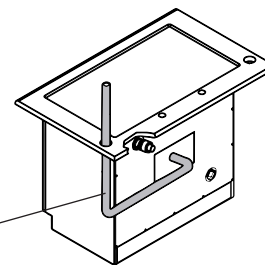

\*Factory Mutual approved  
 & Cabinet height meets ADA Standards.

# Protector® Standard Storage Cabinets

## Features & Dimensional Data



### All models feature:

- Used for non-chemical storage
- Support all Labconco benchtop fume hoods
- Support loads up to 800 lbs.
- Durable powder-coated steel construction
- Glacier white exterior complements laboratory casework and Labconco fume hoods
- Manual-closing, non-locking doors
- Include leveling feet and one 8" filler panel to increase cabinet depth to 30"

### Option includes:

- Lower height (31.5" to 32.5") that meets ADA Standards

### Optional accessories include:

- Interior Shelf Kits. See page 7
- Additional Filler Panels. See page 3

### All models require (not included):

- Work surface. See pages 14-19

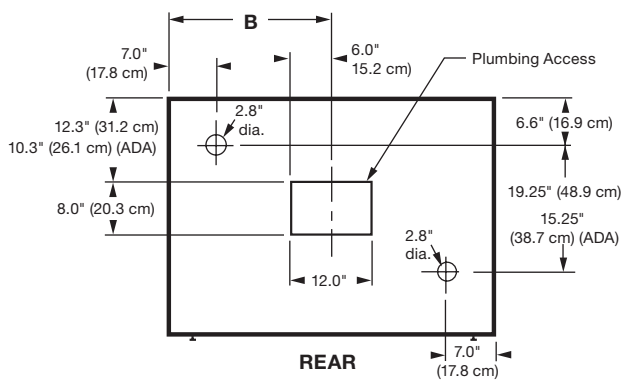
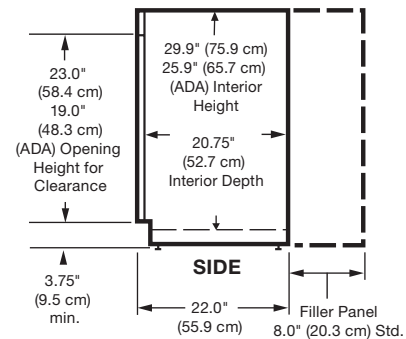
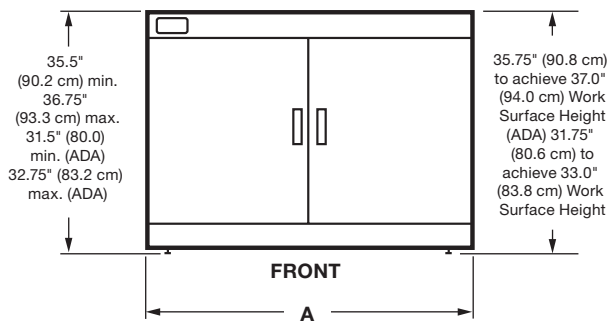

Model(s)	A	B
48" & 48" ADA	48.0" (121.9 cm)	24.0" (61.0 cm)
36" & 36" ADA	36.0" (91.4 cm)	18.0" (45.7 cm)
30" & 30" ADA	30.0" (76.2 cm)	15.0" (38.1 cm)
24" & 24" ADA	24.0" (61.0 cm)	12.0" (30.5 cm)
18" & 18" ADA	18.0" (45.7 cm)	9.0" (22.9 cm)

# Protector® Standard Storage Cabinets

## Ordering Information & Accessories



Catalog Number	Dimensions (w x d x h)	Depth With Filler Panel	Door(s)	Shipping Weight	ADA 
9900000	48.0" x 22.0" x 35.5" to 36.75" (121.9 x 55.9 x 90.2 to 93.3 cm)	30.0" (76.2 cm)	Dual	150 lbs. (118 kg)	
9900100	36.0" x 22.0" x 35.5" to 36.75" (91.4 x 55.9 x 90.2 to 93.3 cm)	30.0" (76.2 cm)	Dual	135 lbs. (82 kg)	
9900200	30.0" x 22.0" x 35.5" to 36.75" (76.2 x 55.9 x 90.2 to 93.3 cm)	30.0" (76.2 cm)	Dual	130 lbs. (70 kg)	
9904800	48.0" x 22.0" x 31.5" to 32.75" (121.9 x 55.9 x 80.0 to 83.2 cm)	30.0" (76.2 cm)	Dual	150 lbs. (68 kg)	•
9904700	36.0" x 22.0" x 31.5" to 32.75" (91.4 x 55.9 x 80.0 to 83.2 cm)	30.0" (76.2 cm)	Dual	135 lbs. (61 kg)	•
9904600	30.0" x 22.0" x 31.5" to 32.75" (76.2 x 55.9 x 80.0 to 83.2 cm)	30.0" (76.2 cm)	Dual	145 lbs. (65 kg)	•
9900300	24.0" x 22.0" x 35.5" to 36.75" (61.0 x 55.9 x 90.2 to 93.3 cm)	30.0" (76.2 cm)	Single Right Hinge	110 lbs. (50 kg)	
9900400	18.0" x 22.0" x 35.5" to 36.75" (45.7 x 55.9 x 90.2 to 93.3 cm)	30.0" (76.2 cm)	Single Right Hinge	105 lbs. (48 kg)	
9900500	12.0" x 22.0" x 35.5" to 36.75" (30.5 x 55.9 x 90.2 to 93.3 cm)	30.0" (76.2 cm)	Single Right Hinge	100 lbs. (45 kg)	
9900600	24.0" x 22.0" x 35.5" to 36.75" (61.0 x 55.9 x 90.2 to 93.3 cm)	30.0" (76.2 cm)	Single Left Hinge	110 lbs. (50 kg)	
9900700	18.0" x 22.0" x 35.5" to 36.75" (45.7 x 55.9 x 90.2 to 93.3 cm)	30.0" (76.2 cm)	Single Left Hinge	105 lbs. (48 kg)	
9900800	12.0" x 22.0" x 35.5" to 36.75" (30.5 x 55.9 x 90.2 to 93.3 cm)	30.0" (76.2 cm)	Single Left Hinge	100 lbs. (45 kg)	
9904000	24.0" x 22.0" x 31.5" to 32.75" (61.0 x 55.9 x 80.0 to 83.2 cm)	30.0" (76.2 cm)	Single Right Hinge	100 lbs. (45 kg)	•
9904100	18.0" x 22.0" x 31.5" to 32.75" (45.7 x 55.9 x 80.0 to 83.2 cm)	30.0" (76.2 cm)	Single Right Hinge	95 lbs. (43 kg)	•
9904200	12.0" x 22.0" x 31.5" to 32.75" (30.5 x 55.9 x 80.0 to 83.2 cm)	30.0" (76.2 cm)	Single Right Hinge	85 lbs. (39 kg)	•
9904300	24.0" x 22.0" x 31.5" to 32.75" (61.0 x 55.9 x 80.0 to 83.2 cm)	30.0" (76.2 cm)	Single Left Hinge	100 lbs. (45 kg)	•
9904400	18.0" x 22.0" x 31.5" to 32.75" (45.7 x 55.9 x 80.0 to 83.2 cm)	30.0" (76.2 cm)	Single Left Hinge	90 lbs. (41 kg)	•
9904500	12.0" x 22.0" x 31.5" to 32.75" (30.5 x 55.9 x 80.0 to 83.2 cm)	30.0" (76.2 cm)	Single Left Hinge	90 lbs. (41 kg)	•



**Interior Shelf Kits.** Include powder-coated steel shelf and mounting hardware.

Catalog Number	Nominal Width	Shipping Weight
9919100	48"	25 lbs. (11 kg)
9919101	36"	20 lbs. (9 kg)
9919102	30"	18 lbs. (8 kg)
9919103	24"	15 lbs. (7 kg)
9919104	18"	12 lbs. (5 kg)
9919105	12"	10 lbs. (5 kg)

⌘ Cabinet height meets ADA Standards.

# Protector® Vacuum Pump Storage Cabinets

## Ordering Information & Accessories



### All models feature:

- Provide enclosed space for pumps
- Durable powder-coated steel construction
- Glacier white exterior complements laboratory casework and Labconco fume hoods
- Manual-closing, non-locking door
- One 115V, 60 Hz electrical duplex receptacle provides power to a vacuum pump. **Wiring is required**
- Two rear cutouts for pass through of tubing or cabinet ventilation
- Include leveling feet and one 8" filler panel to increase cabinet depth to 30"

### Optional accessories include:

- Vent Kit 3591100. See page 3
- Additional Filler Panels. See page 3

### All models require (not included):

- Work surface. See pages 14-19

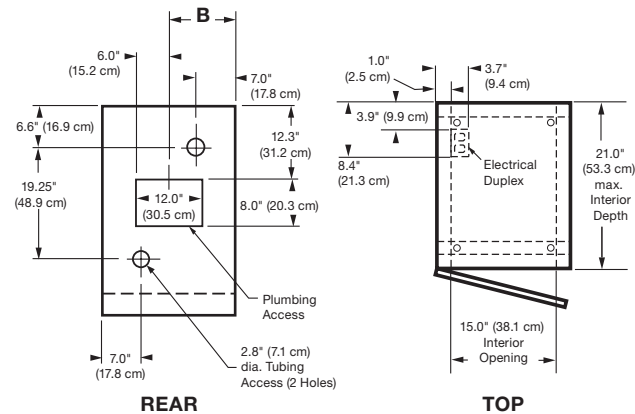
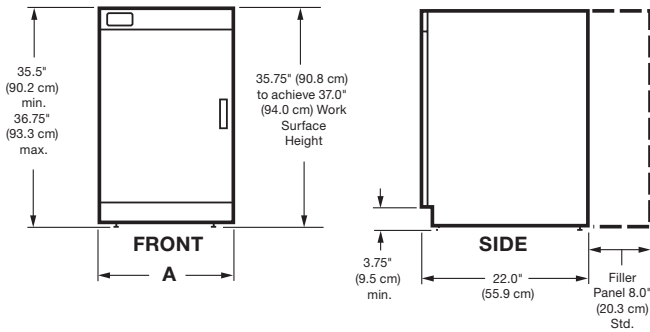

Model	A	B
18"	18.0" (45.7 cm)	9.0" (22.9 cm)
24"	24.0" (61.0 cm)	12.0" (30.5 cm)

Catalog Number	Dimensions (w x d x h)	Depth With Filler Panel	Door	Shipping Weight
9907000	18.0" x 22.0" x 35.5" to 36.75" (46.0 x 55.9 x 90.2 to 93.3 cm)	30.0" (76.2 cm)	Right Hinge	105 lbs. (48 kg)
9907100	18.0" x 22.0" x 35.5" to 36.75" (46.0 x 55.9 x 90.2 to 93.3 cm)	30.0" (76.2 cm)	Left Hinge	105 lbs. (48 kg)
9907200	24.0" x 22.0" x 35.5" to 36.75" (61.0 x 55.9 x 90.2 to 93.3 cm)	30.0" (76.2 cm)	Right Hinge	110 lbs. (50 kg)
9907300	24.0" x 22.0" x 35.5" to 36.75" (61.0 x 55.9 x 90.2 to 93.3 cm)	30.0" (76.2 cm)	Left Hinge	110 lbs. (50 kg)

# ADA Base Stand

## Ordering Information & Dimensional Data



### All models feature:

- Support Labconco fume hoods and enclosures
- Durable 2" tubular, powder-coated steel frame
- Glacier white exterior complements laboratory casework and Labconco fume hoods
- Includes four fixed leveling feet and powder-coated finish panels: two side, one back, and one to hide a sink and plumbing mounted on either side by switching and inverting panels

### Height and knee clearance conform to the following standards:

- ADA

### All models require (not included):

- Work surface without rear sink. See pages 14-19

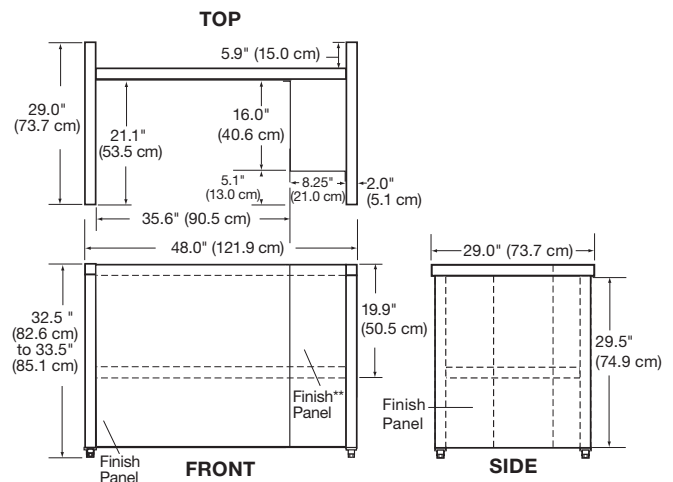

Catalog Number ♿	Nominal Width	Dimensions (w x d x h)	Shipping Weight	For Use With
9938600	4'	48.0" x 29.0" x 32.5"-33.5" (121.9 x 73.7 x 82.6-85.1 cm)	105 lbs. (48 kg)	Basic 47™*; Paramount®, Protector XStream®, Premier®, XL™, Airo™, Echo™, XVS™, Work Station

\*Basic 47 Hood is narrower than the supporting base stand.

\*\*Finish panel may be switched and inverted to hide plumbing on the left-hand side.

♿Stand height meets ADA Standards.

# Telescoping Base Stands

## Specifications & Accessory



### All models feature:

- Support Labconco fume hoods and enclosures
- Support loads to 4000 lbs.
- Durable 1.75" tubular, glacier white powder-coated steel
- Adjust to eight height positions in 1" increments from 27.5" to 34.5"\*
- For 37.7" deep hoods with cupsink, order left or right rear sink location only

### Height and knee clearance conform to the following standards:

- ADA

### Options include:

- Fixed leveling feet
- 5" dia., toe-locking, non-marking polyurethane casters

### Optional accessories include include:

- Shelf Kits

### All models require (not included):

- Work surface. See pages 14-19

**Shelf Kits.** Powder-coated 18 gauge steel. Hook on lower cross members. 9.9" (25.1 cm) deep. Do not meet ADA standard for knee clearance.

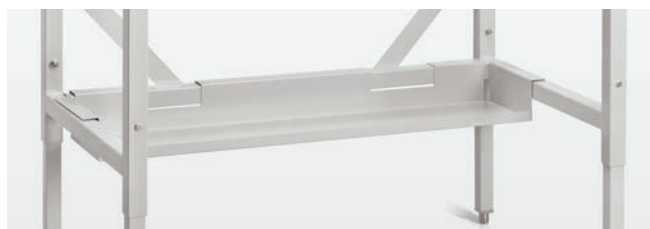

Shelf Width	Catalog Number	Actual Width	Shipping Weight
3'	<b>3811101</b>	36.0" (91.4 cm)	12 lbs. (5 kg)
4'	<b>3811102</b>	48.0" (121.9 cm)	16 lbs. (7 kg)
5'	<b>3811103</b>	60.0" (152.4 cm)	19 lbs. (9 kg)
6'	<b>3811104</b>	72.0" (152.4 cm)	23 lbs. (10 kg)

\*Height selection and adjustment are required before the hood or enclosure is installed atop the stand.

# Telescoping Base Stands

## Ordering Information & Dimensional Data

### With Fixed Feet

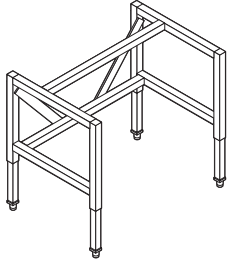

Nominal Width	Catalog Number	Actual Width (A)	Shipping Weight	For Use With
2'	<b>3746700</b>	24.0" (61.0 cm)	80 lbs. (36 kg)	Paramount, Protector XVS
3'	<b>3746701</b>	36.0" (91.4 cm)	95 lbs. (43 kg)	Fiberglass 30*; Paramount; Protector XL, Airo, XVS, Demonstration
4'	<b>3746702</b>	48.0" (121.9 cm)	99 lbs. (45 kg)	Basic 47*; Paramount; Protector XStream, Premier, XL, Echo, Airo, XVS, Work Station
5'	<b>3746703</b>	60.0" (152.4 cm)	115 lbs. (52 kg)	Protector XStream, Premier, Echo, XVS, XL; Paramount
6'	<b>3746704</b>	72.0" (182.8 cm)	120 lbs. (54 kg)	Protector XStream, Premier, Echo, XVS, XL; Paramount; Basic 70*

### With 5" Dia. Toe-Locking Casters\*\*

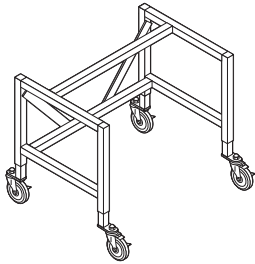

Nominal Width	Catalog Number	Actual Width (A)	Shipping Weight	For Use With
2'	<b>3746710</b>	24.0" (61.0 cm)	65 lbs. (29 kg)	Paramount, Protector XVS
3'	<b>3746711</b>	36.0" (91.4 cm)	95 lbs. (43 kg)	Paramount; Protector Airo, XVS, Demonstration
4'	<b>3746712</b>	48.0" (121.9 cm)	110 lbs. (50 kg)	Paramount; Protector Echo, Airo, XVS, Work Station
5'	<b>3746713</b>	60.0" (152.4 cm)	116 lbs. (53 kg)	Paramount, Protector Echo, XVS
6'	<b>3746714</b>	72.0" (182.8 cm)	125 lbs. (57 kg)	Paramount; Protector Echo, XVS

#### WITH FIXED FEET

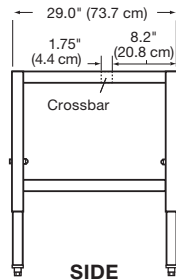
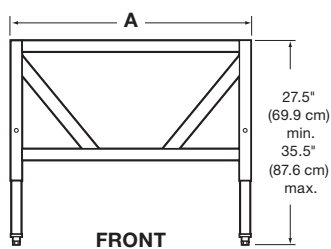

#### WITH CASTERS

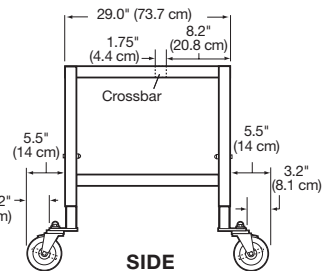
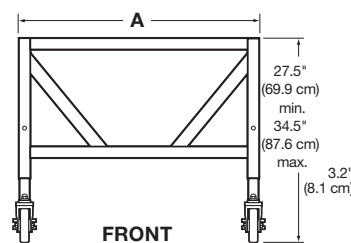

\*Basic and Fiberglass 30 Hoods are narrower than the base stands that support them.

\*\*Enclosures supported by mobile base stands will require special modifications to incorporate flexible ducting, wiring and plumbing when applied.

# Electric & Manual Hydraulic Lift Base Stands

## Specifications & Accessory



### All models feature:

- Support Labconco fume hoods and enclosures
- Support loads up to 1000 lbs.
- Durable 1.75" tubular, powder-coated steel frame with rear crossbar supports. Support frame is 2.0" x 3.0"
- Glacier white exterior complements laboratory casework and Labconco products
- Accommodate persons of different heights and wheelchair-bound users
- Height is infinitely adjustable from 25.5" to 33.5"
- When coupled with a flat work surface, stands may be used alone as an adjustable height table
- 36" deep SpillStopper™ Work Surfaces are not compatible with side cupsink cutouts
- Include four powder-coated, die-cast feet with levelers

### Height and knee clearance conform to the following standards:

- ADA

### Electric Lift models feature:

- Front-accessible, right-side up/down switch. Models for 115 volt, 60 Hz operation include 12-foot, 3-wire cord and plug. Models for 230 volt, 50 Hz operation include 12-foot, 3-wire cord and NEMA 6-15P plug

### Manual Lift models feature:

- Front-accessible, right-side hand crank. Turning crank clockwise raises stand; counterclockwise lowers it. Handle may be disengaged and folded under, out of the way, when not in use

### Optional accessory includes:

- Caster Kit

### All models require (not included):

- Work surface. See pages 14-19

**3784000—Caster Kit.\*** Casters add mobility to the Hydraulic Lift Base Stand. Includes four 5" dia., non-marking polyurethane casters with toe locks. Load rating for each caster is 250 lbs. Have bearings for quiet operation. Replace fixed feet that are included with stand. **Installation is required.** Shipping weight 10 lbs. (5 kg)



\* Enclosures supported by mobile base stands will require special modifications to incorporate flexible ducting, wiring and plumbing when applied.

# Electric & Manual Hydraulic Lift Base Stands

## Ordering Information & Dimensional Data

### Electric Hydraulic Lift

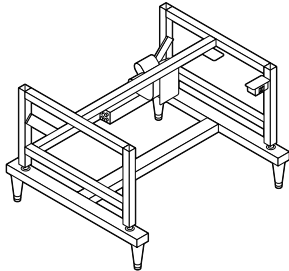

Nominal Width	Catalog Number	Dimensions (w x d)	Electrical Requirements	Shipping Weight	For Use With
3'	<b>3780300</b>	37.2" x 34.3" (94.5 x 87.1 cm)	115V, 60 Hz, 2.4A	105 lbs. (48 kg)	Paramount; Protector Airo, XVS, Demonstration
3'	<b>3780303*</b>	37.2" x 34.3" (94.5 x 87.1 cm)	230V, 50/60 Hz, 0.8A	105 lbs. (48 kg)	Paramount; Protector Airo, Echo, XVS, Demonstration
4'	<b>3780301</b>	49.2" x 34.3" (125.0 x 87.1 cm)	115V, 60 Hz, 2.4A	175 lbs. (79 kg)	Paramount; Protector Airo, Echo, XVS, Work Station**
4'	<b>3780304*</b>	49.2" x 34.3" (125.0 x 87.1 cm)	230V, 50/60 Hz, 0.8A	175 lbs. (79 kg)	Paramount; Protector Airo, Echo, XVS, Work Station**
6'	<b>3780302</b>	73.2" x 34.3" (185.9 x 87.1 cm)	115V, 60 Hz, 2.4A	210 lbs. (95 kg)	Paramount; Protector Echo, XVS
6'	<b>3780305*</b>	73.2" x 34.3" (185.9 x 87.1 cm)	230V, 50/60 Hz, 0.8A	210 lbs. (95 kg)	Paramount; Protector Echo, XVS

### Manual Hydraulic Lift

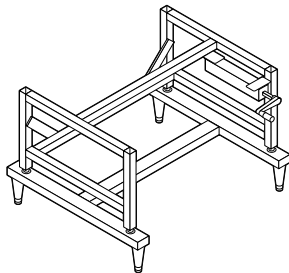

Nominal Width	Catalog Number	Dimensions (w x d)	Electrical Requirements	Shipping Weight	For Use With
3'	<b>3780400</b>	37.2" x 34.3" (94.5 x 87.1 cm)	115V, 60 Hz, 2.4A	130 lbs. (59 kg)	Paramount; Protector Airo, XVS, Demonstration
4'	<b>3780401</b>	49.2" x 34.3" (125.0 x 87.1 cm)	230V, 50/60 Hz, 0.8A	160 lbs. (73 kg)	Paramount; Protector Airo, Echo, XVS, Work Station
6'	<b>3780402</b>	73.2" x 34.3" (185.9 x 87.1 cm)	115V, 60 Hz, 2.4A	235 lbs. (107 kg)	Paramount; Protector Echo, XVS

#### ELECTRIC LIFT

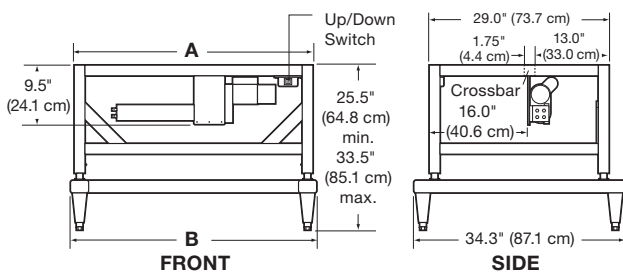

#### MANUAL LIFT

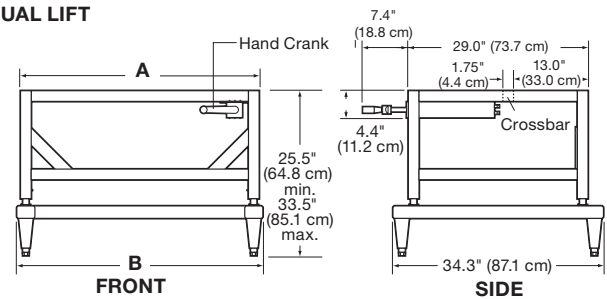







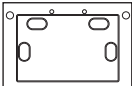

Model	A	B
36"	36.0" (91.4 cm)	37.2" (94.5 cm)
48"	48.0" (121.9 cm)	49.2" (125.0 cm)
72"	72.0" (182.9 cm)	73.2" (185.9 cm)

\*International electrical configuration

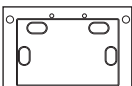
\*\*Not compatible with Work Surface with Sink 6942003

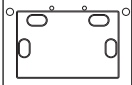
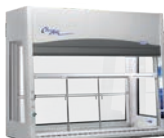
# SpillStopper™ & Flat Work Surfaces

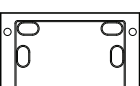
## Selection Guide

For Use with Hood	Nominal Width	Work Surface	Cupsink Cutout Options	Page(s)
 <p><b>Protector XStream, Premier &amp; XL</b></p>	3', 4', 5', 6', 7', 8', 10', 12'	<b>SpillStopper</b>	 <p>Left Rear, Right Rear, Left Side, Right Side</p>	16-17
 <p><b>Protector Echo</b></p>	4', 5', 6', 8'	<b>SpillStopper</b>	 <p>Left Rear, Right Rear, Left Side, Right Side</p>	16-17
 <p><b>Protector Airo</b></p>	3', 4'	<b>SpillStopper</b>	 <p>Left Rear, Right Rear, Left Side, Right Side</p>	16-17
 <p><b>Protector ClassMate</b></p>	4', 5', 6'	<b>SpillStopper</b>	 <p>Left Rear, Right Rear, Left Side, Right Side</p>	18
 <p><b>Protector Pass-Through</b></p>	4', 5', 6'	<b>SpillStopper</b>	 <p>Left Rear, Right Rear, Left Side, Right Side</p>	19
 <p><b>Basic 47 and 70</b></p>	4', 6'	<b>Flat</b>	Custom cutout required or use optional Cupsink and Turret Kit (4852500). Contact Labconco	15
 <p><b>Fiberglass 30</b></p>	3'	<b>Flat</b>	Custom cutout required. Contact Labconco	15

# SpillStopper™ & Flat Work Surfaces

## Specifications, Accessories & Ordering Information

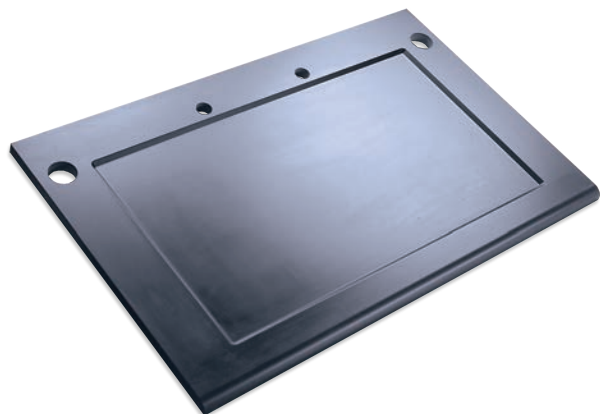

### All SpillStopper Work Surfaces feature:

- Support Protector XStream, Premier, XL, Echo, Airo, ClassMate and Pass-Through Hoods
- Molded from special formulation corrosion-resistant epoxy resins
- Dished and contoured to conform to interior liner
- Pre-drilled holes for venting and plumbing pass-through

### Models for use with Protector XStream, Premier, XL, Echo and Airo Hoods feature:

- Front edge with large aerodynamic radius to direct air into the hood

### Option includes:

- 6.0" x 3.0" (15.2 x 7.6 cm) oval cupsink cutout(s). Cupsink(s) sold separately

### Optional accessories include:

- Deck-mounted accessories requiring custom cutouts. See page 20
- Oval Polypropylene Cupsink
- Cupsink Cover



### 4005200—Oval Polypropylene Cupsink.

Mounts in work surface with cupsink cutout, 6.0" x 3.0" (15.2 x 7.6 cm). 1.5" (5.8 cm) National Pipe Straight Mechanical (NPSM) thread. Shipping weight 2.0 lbs. (0.9 kg)



### 4005201—Cupsink Cover.

Black solid epoxy resin cover for oval cupsink cutout. Provides a continuous work surface when cupsink is not in use. 7.4" w x 4.4" d x 0.3" thick (18.8 x 11.2 x 0.8 cm). Shipping weight 2.0 lbs. (0.9 kg)



### All Flat Work Surfaces feature:

- Support Labconco enclosures including Fiberglass 30 and Basic 47 and 70 Hoods.\* Also use with other hoods and as a countertop
- Corrosion-resistant solid epoxy

### Optional accessories include:

- Deck-mounted accessories requiring custom cutouts. See page 20

Catalog Number	Description	Shipping Weight
4882806	30.0" w x 30.0" d x 1.25" thick (76.2 x 76.2 x 3.2 cm), no cutouts	87 lbs. (39 kg)
4882805	36.0" w x 30.0" d x 1.25" thick (91.4 x 76.2 x 3.2 cm), no cutouts	100 lbs. (45 kg)
4882803	48.0" w x 30.0" d x 1.25" thick (121.9 x 76.2 x 3.2 cm), no cutouts	165 lbs. (75 kg)
4882804	72.0" w x 30.0" d x 1.25" thick (182.9 x 76.2 x 3.2 cm), no cutouts	205 lbs. (93 kg)

\*Basic Hoods and Fume Adsorbers are not as wide or as deep as the work surfaces that support them.

# SpillStopper™ Work Surfaces

For Use With Protector® Premier®, XStream®, XL™, Echo™ & Airo™ Laboratory Hoods

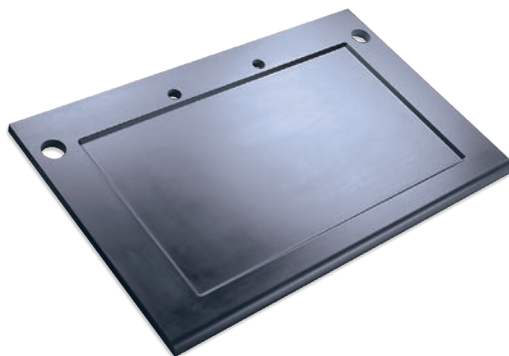

## Catalog Number Configurator:

Use this key to configure the seven digit catalog number to order the SpillStopper Work Surface for use with your Protector Premier, XStream, XL, Echo or Airo Hood.

9 5 0

Select the **MODEL** and **EXTERIOR DEPTH** of your fume hood. This is the fourth digit of your catalog number.

- 0 = Premier, XL, Airo with 31.7" depth
- 1 = XL, Echo, Airo with 37.7" depth
- 2 = XL with 43.7" depth
- 3 = XStream with 37.7" depth

Select the **NOMINAL WIDTH** of your fume hood. This is the fifth digit of your catalog number.

- 3 = 3'
- 4 = 4'
- 5 = 5'
- 6 = 6'
- 7 = 7'
- 8 = 8'
- 0 = 10'
- 1 = 12'
- 2 = 16'

Select a **LEFT CUPSINK CUTOUT** option. Cupsink is sold separately, see page 15. This is the sixth digit of your catalog number.

- 0 = None
- 1 = Rear
- 2 = Side\*\*

Select a **RIGHT CUPSINK CUTOUT** option. Cupsink is sold separately, see page 15. This is the seventh digit of your catalog number.

- 0 = None
- 1 = Rear
- 2 = Side\*\*

\*Protector XL Laboratory Hoods only.

\*\*Not compatible with Protector Solvent Storage Cabinets.

# SpillStopper™ Work Surfaces

For Use With Protector® Premier®, XStream®, XL™, Echo™ & Airo™ Laboratory Hoods

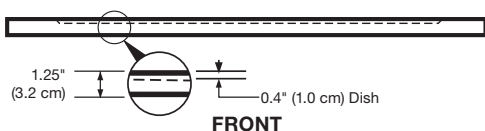
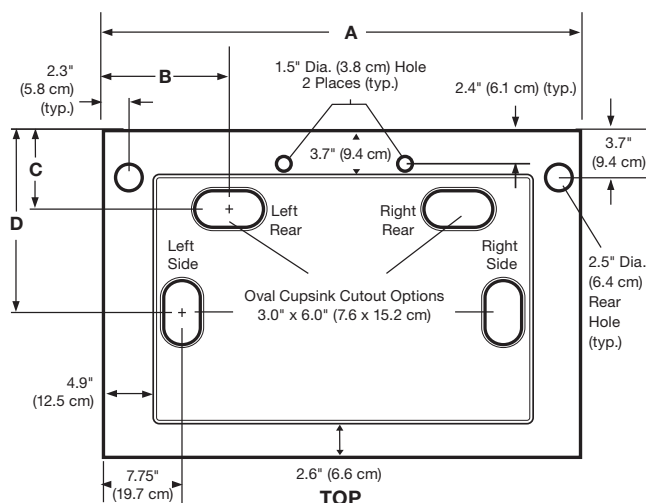

Hood Model(s)/ Depth	Work Surface Depth	B	C	D
Premier XL, Airo, 31.7"	30.0" (76.2 cm)	9.5" (24.1 cm)	4.6" (11.7 cm)	18.8" (47.8 cm)
XL, Echo, Airo, 37.7"	36.0" (91.4 cm)	12.5" (31.8 cm)	7.3" (18.5 cm)	19.0" (48.3 cm)
XL, 43.7"	42.0" (106.7 cm)	12.5" (31.8 cm)	7.3" (18.5 cm)	14.9" (37.8 cm)
XStream, 37.7"	36.0" (91.4 cm)	12.5" (31.8 cm)	10.3" (26.2 cm)	19.0" (48.3 cm)

Nominal Width	Hood Model(s)	Hood Exterior Depth	Hood & Work Surface Width (A)	Work Surface Shipping Weight
3'	XL, Airo	31.7"	36.0" (91.4 cm)	85 lbs. (39 kg)
	XL, Airo	37.7"		90 lbs. (41 kg)
	XL	43.7"	105 lbs. (48 kg)	
4'	Premier, XL	31.7"	48.0" (121.9 cm)	110 lbs. (50 kg)
	XStream, XL, Echo, Airo	37.7"		120 lbs. (54 kg)
	XL	43.7"	140 lbs. (64 kg)	
5'	Premier, XL	31.7"	60.0" (152.4 cm)	150 lbs. (68 kg)
	XStream, XL, Echo	37.7"		160 lbs. (73 kg)
	XL	43.7"	180 lbs. (82 kg)	
6'	Premier, XL	31.7"	72.0" (182.9 cm)	205 lbs. (93 kg)
	XStream, XL, Echo	37.7"		220 lbs. (100 kg)
	XL	43.7"	250 lbs. (113 kg)	
7'	XL	31.7"	84.0" (213.3 cm)	210 lbs. (95 kg)
		37.7"		230 lbs. (104 kg)
	XL	43.7"	270 lbs. (122 kg)	
8'	Premier, XL	31.7"	96.0" (243.8 cm)	240 lbs. (109 kg)
	XStream, XL, Echo	37.7"		250 lbs. (113 kg)
	XL	43.7"	290 lbs. (132 kg)	
10'	XL	31.7"	120.0** (304.8 cm)	290 lbs. (132 kg)
		37.7"		370 lbs. (168 kg)
	XL	43.7"	480 lbs. (218 kg)	
12'	XL	31.7"	144.0** (365.8 cm)	320 lbs. (145 kg)
		37.7"		440 lbs. (200 kg)
	XL	43.7"	500 lbs. (227 kg)	
16'	XL	31.7"	192.0** (487.7 cm)*	350 lbs. (159 kg)
		37.7"		480 lbs. (218 kg)
	XL	43.7"	550 lbs. (249 kg)	

\*Shipped in two equal width sections.

# SpillStopper™ Work Surfaces

For Use With Protector® ClassMate® Laboratory Hoods



## Catalog Number Configurator:

Use this key to configure the seven digit catalog number to order the SpillStopper Dished Solid Epoxy Work Surface for use with your Protector ClassMate Laboratory Hood.

9 6 0 0

Select the **NOMINAL WIDTH** of your fume hood. This is the fifth digit of your catalog number.

- 4 = 4'
- 5 = 5'
- 6 = 6'

Select a **LEFT CUPSINK CUTOUT** option. Cupsink sold separately, see page 15. This is the sixth digit of your catalog number.

- 0 = None
- 1 = Rear
- 2 = Side\*

Select a **RIGHT CUPSINK CUTOUT** option. Cupsink sold separately, see page 15. This is the seventh digit of your catalog number.

- 0 = None
- 1 = Rear
- 2 = Side\*

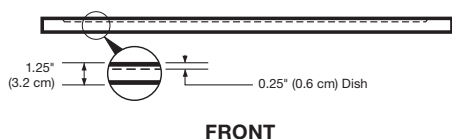
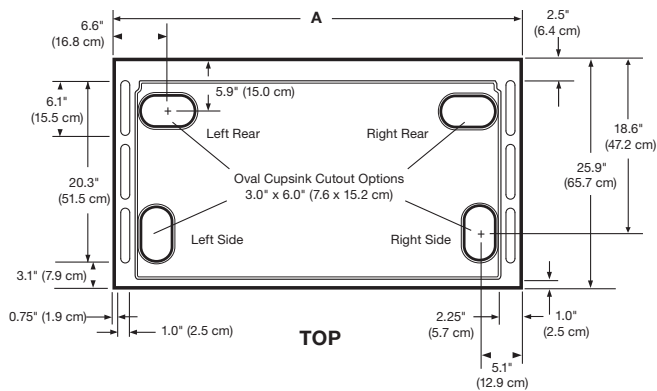

Nominal Width	Actual Width (A)	Shipping Weight
4'	48.0" (121.9 cm)	110 lbs. (50 kg)
5'	60.0" (152.4 cm)	150 lbs. (68 kg)
6'	72.0" (182.9 cm)	205 lbs. (93 kg)

\*Not compatible with Protector Solvent Storage Cabinets.

# SpillStopper™ Work Surfaces

For Use With Protector® Pass-Through Laboratory Hoods

## Catalog Number Configurator:

Use this key to configure the seven digit catalog number to order the SpillStopper Work Surface for use with your Protector Pass-Through Laboratory Hood.

9 5 7 0

Select the **NOMINAL WIDTH** of your fume hood. This is the fifth digit of your catalog number.

4 = 4'      5 = 5'      6 = 6'

Select a **LEFT CUPSINK CUTOUT** option. Cupsink is sold separately, see page 15. This is the sixth digit of your catalog number.

0 = None      1 = Rear      2 = Side\*

Select a **RIGHT CUPSINK CUTOUT** option. Cupsink is sold separately, see page 15. This is the seventh digit of your catalog number.

0 = None      1 = Rear      2 = Side\*

Nominal Width	A	B	Shipping Weight
4'	48.0" (121.9 cm)	43.3" (109.9 cm)	110 lbs. (50 kg)
5'	60.0" (152.4 cm)	55.3" (140.4 cm)	150 lbs. (68 kg)
6'	72.0" (182.9 cm)	67.3" (170.9 cm)	205 lbs. (93 kg)

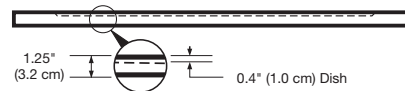
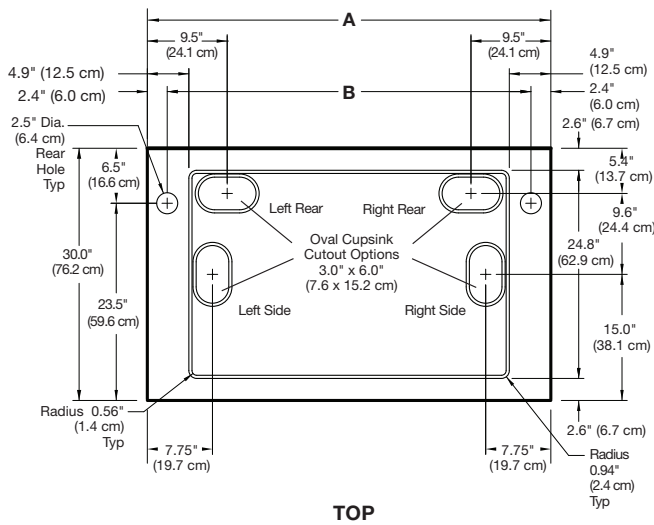

\*Not compatible with Protector Solvent Storage Cabinets.

# Deck-Mounted Accessories

## Ordering Information

These accessories require a custom factory-prepared or on-site modified work surface.

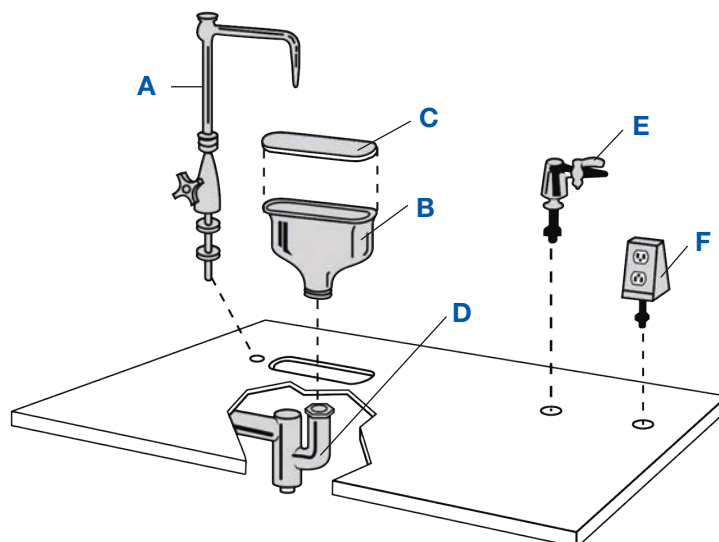

**(A) 4005100—Cold Water Faucet with Rigid Gooseneck.** Mounting hole, 0.812" dia. in work surface is required (not included).\* Shipping weight 7.0 lbs. (3.2 kg)

**(A) 4005900—Cold Water Faucet with Rigid Gooseneck & Vacuum Breaker.** Mounting hole in work surface is required (not included).\* Shipping weight 7.0 lbs. (3.2 kg)

**1361200—Chrome-Plated Cold & Hot Water Mixing Faucet with Swivel Gooseneck.** Not shown. Mounting hole, 0.750" dia., in work surface is required (not included). Shipping weight 7.0 lbs. (3.2 kg)

**(B) 4005200—Oval Polypropylene Cupsink.** Mounts in work surface with cupsink cutout. 3.0" w x 6.0" d (7.6 x 15.2 cm). 1.5" NPSM thread. Shipping weight 2.0 lbs. (0.9 kg)

**(C) 4005201—Cupsink Cover.** Black solid epoxy resin cover for oval cupsink cutout. Provides a continuous work surface when cupsink is not in use. 7.4" w x 4.4" d x 0.3" thick (18.8 x 11.2 x 0.8 cm). Shipping weight 2.0 lbs. (0.9 kg)

**(D) 1432600—Trap, PVC.** 1.5" dia. drum with coupling nut. For use with cupsink. Shipping weight 10 lbs. (5 kg)

**(E) 4005000—Service Fixture.** Specify air, gas or vacuum. Mounting hole, 0.750" dia., in work surface is required (not included).\* Shipping weight 4.0 lbs. (1.8 kg)

**(F) 4005800—Electrical Receptacle Pedestal-type.** 115V, 15A duplex. For 3/4 IPS conduit. Mounting hole, 1.125" dia., in work surface is required (not included).\* Shipping weight 4.0 lbs. (1.8 kg)

\*Contact Labconco for factory-drilled mounting holes.

# Service Fixture Kits

## Ordering Information

**Service Fixture Kits** include one remotely-controlled service fixture with valve, color-coded fixture knob and hose connector.\* **Inlet tubing is not included.** Not for use with 43.7" and 55.7"

exterior depth XL hoods. Stainless Steel and PVC hoods require drilled hole in liner. Except for vacuum, the maximum allowable pressure is 200 psi with a working pressure of 40 psi.

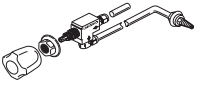
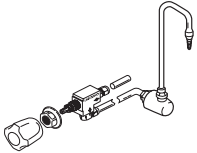
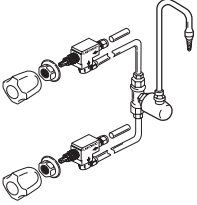
Kit	Catalog Number	Service Type	Tubing Material & Diameter	Valve	Knob Color	Maximum Flow Rate	Working Pressure**	Shipping Weight
	9808300	Cold Water (CW)	Copper, 0.25"	Brass	Green	3.5 GPM (13.2 LPM)	40 psi	4.0 lbs. (1.8 kg)
	9808400	Air (AIR)	Copper, 0.25"	Brass	Orange	23.7 CFM	40 psi	4.0 lbs. (1.8 kg)
	9808500	Vacuum (VAC)	Copper, 0.25"	Brass	Yellow	8.6 CFM	14.7 psi	4.0 lbs. (1.8 kg)
	9808700	Gas (GAS)	Brass, 0.25"	Brass	Blue	29.0 CFM (441 BTU/sec)	40 psi	4.0 lbs. (1.8 kg)
	9808800	Argon (ARG)	Copper, 0.25"	Brass	Gray	20.2 CFM	40 psi	4.0 lbs. (1.8 kg)
	9808900	Hot Water (HW)	Copper, 0.25"	Brass	Red	3.5 GPM (13.2 LPM)	40 psi	4.0 lbs. (1.8 kg)
	9809100	Deionized (DI)/ Distilled Water (DW)	Stainless Steel, 0.25"	Nickel-Plated & Stainless Steel	White	3.5 GPM (13.2 LPM)	40 psi	4.0 lbs. (1.8 kg)
	9809200	Steam (STM)	Copper, 0.25"	Brass	Black	0.5 LBM/min	40 psi	4.0 lbs. (1.8 kg)
	9809300	Nitrogen (NIT)	Copper, 0.25"	Brass	Brown	24.1 CFM	40 psi	4.0 lbs. (1.8 kg)
	9809700*	Oxygen (OXY)	Copper, 0.25"	Brass with Oxygen-Compatible Lubricant	Light Green	22.6 CFM	40 psi	4.0 lbs. (1.8 kg)
	9827900	Cold water (CW) green epoxy-coated brass gooseneck	Copper, 0.375"	Brass	Green	3.5 GPM	40 psi	10 lbs. (5 kg)
	9857700†	Cold water (CW) gray PVC swivel gooseneck	Copper, 0.375"	Brass	Green	3.5 GPM	40 psi	10 lbs. (5 kg)
	9853400†	Deionized (DI)/ distilled water (DW) gray PVC swivel gooseneck	Stainless steel, 0.25"	Stainless steel	White	3.5 GPM	40 psi	10 lbs. (5 kg)
	9828000	Hot (HW) & cold water (CW) mixing white epoxy-coated gooseneck	Copper, 0.25"	Brass	Green & Red	3.5 GPM	40 psi	11 lbs. (5 kg)

GPM=gallons per minute LPM=liters per minute CFM=cubic feet per minute BTU/sec=British thermal unit per second LBM/min=pounds mass per minute

\*Contact Labconco for ordering information on chrome-plated brass hose connectors for stainless steel hoods.

\*\*Recommended working pressure

†Requires 1.125" dia. drill hole in liner

# Fume Hood Accessories

**Electrical Receptacle Kits.** For mounting on left or right side of any 3'-8' Protector Premier, XStream, XL, Echo, Airo, PVC or Stainless Steel Hood. Include electrical receptacle, cover plate, wiring and junction box. **Requires hard wiring and unique circuit.** Contact Labconco for ordering information on 10', 12' or 16' hoods. Shipping weight 4.0 lbs. (1.8 kg)



Duplex Electrical Receptacle Kit  
9851500

## 3925000—Utility Shelves.\*

Three powder-coated steel shelves attach to rear baffle slots to hold items. Utensil shelf has scalloped front edge to support scalpels, forceps and other items. Shipping weight 5.0 lbs. (2.3 kg)

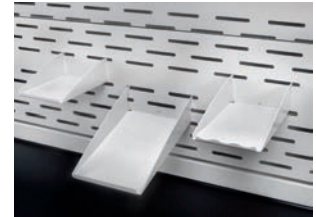

## 3927800—Tissue Holder.\*

Attaches to rear baffle slots to hold tissues. Powder-coated steel. Shipping weight 1.0 lb. (0.5 kg)



## Plug Configurations



115V, 60 Hz, 20A  
for North America



230V, 20A, 60 Hz  
for North America



230V, 50 Hz  
for Great Britain (UK)



230V, 50 Hz  
Schuko



230V, 50 Hz  
for China/Australia



230V, 50 Hz  
for India/South Africa

## 3927700—Bottle Holder.\*

Powder-coated steel. Attaches to rear baffle slots to hold bottles. 3" dia. opening. Shipping weight 1.0 lb. (0.5 kg)



Catalog Number	Kit	Outlet Type
9851100	115V, 20A AC, 60 Hz	Duplex, U.S.
9851500	115V, 20A AC, GFCI, 60 Hz	Duplex, U.S.
9854200	230V, 20A AC, 60 Hz	Duplex, U.S.
9412500	230V, 13A AC, 50 Hz	Single, British (UK)
9412700	230V, 16A AC, 50 Hz	Single, Schuko
9412900	230V, 10A AC, 50 Hz	Single, China
9413100	230V, 10A AC, 50 Hz	Single, Australia
9413900	230A, 6-16A AC, 50 Hz	Single, India-South Africa
9414100	International GFCI Switch, 16A	Not applicable

**Sash Stop Kits.** Restrict how far a vertical-rising sash may be opened. Protector XStream, Premier and 3' to 12' XL Hoods are factory prepared for a sash stop at the 62.5% open position (18" above the work surface). Protector Echo and Airo Hoods are factory prepared at 16" above the work surface. Alternate positions may be field drilled. Includes components for one sash. Plastic. Shipping weight 0.5 lb. (0.2 kg)

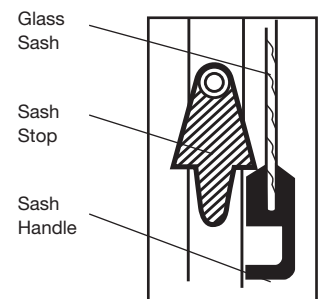

Catalog Number	For Use With Hood
9410300	Protector XStream, Premier, XL, Echo, Airo
4965901	Basic 47 and 70

\*For use with Paramount Ductless Enclosures; Protector XStream and XL Laboratory Hoods, XVS Ventilation and Work Stations

\*\*The International GFCI switch takes the place of one electrical outlet corner post location.

# Fume Hood Accessories

Nominal Width	For Use With Protector Hood	Catalog Number	Shipping Weight	Catalog Number	Shipping Weight
			<b>Stainless Steel Rods &amp; Connectors</b>		<b>Fiberglass Rods &amp; Connectors</b>
4'	ClassMate	<b>6973300</b>	15 lbs. (7 kg)	—	—
5'	ClassMate	<b>6973301</b>	20 lbs. (9 kg)	—	—
6'	ClassMate	<b>6973302</b>	25 lbs. (11 kg)	—	—
4'	Premier, XStream, XL Benchtop	<b>9725204</b>	10 lbs. (5 kg)	<b>9725214</b>	8.0 lbs. (3.6 kg)
5'	Premier, XStream, XL Benchtop	<b>9725205</b>	15 lbs. (7 kg)	<b>9725215</b>	12 lbs. (6 kg)
6'	Premier, XStream, XL Benchtop	<b>9725206</b>	20 lbs. (9 kg)	<b>9725216</b>	16 lbs. (7 kg)
8'	Premier, XStream, XL Benchtop	<b>9725200</b>	25 lbs. (11 kg)	<b>9725218</b>	20 lbs. (9 kg)
10'	XL Benchtop	<b>9725201</b>	30 lbs. (14 kg)	—	—
12'	XL Benchtop	<b>9725202</b>	35 lbs. (16 kg)	—	—
16'	XL Benchtop	<b>9725203</b>	45 lbs. (20 kg)	—	—
4'	XL Floor-Mount	<b>9725244</b>	20 lbs. (9 kg)	—	—
5'	XL Floor-Mount	<b>9725245</b>	30 lbs. (14 kg)	—	—
6'	XL Floor-Mount	<b>9725246</b>	40 lbs. (18 kg)	—	—
8'	XL Floor-Mount	<b>9725240</b>	50 lbs. (23 kg)	—	—
10'	XL Floor-Mount	<b>9725241</b>	60 lbs. (27 kg)	—	—
12'	XL Floor-Mount	<b>9725242</b>	70 lbs. (32 kg)	—	—
16'	XL Floor-Mount	<b>9725243</b>	90 lbs. (41 kg)	—	—

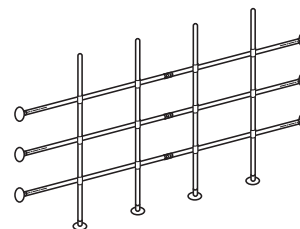

**Distillation Grid Kits.** Rods, connectors, instructions and drill template included. **Requires installation including drill holes.**

**Snuffer™ Fire Extinguishers.** Fusible link activates at 155° F (68° C), ABC chemical powder automatically discharges to extinguish the fire. Pressure gauge permits visual inspection. Rechargeable. Stainless steel cylinder mounts vertically above hood liner. UL\*\* listed. **Drilled holes are required in liner and baffle.** Labconco recommends factory prep. Not for use with Protector Premier Hoods with built-in blower or Fiberglass 30, Basic, Protector Echo or Protector Airo Hoods.



Catalog Number	For Use With Protector Hood	Shipping Weight
<b>1115005</b>	Premier, XStream, XL, Pass-Through, 6' ClassMate	6.0 lbs. (2.7 kg)
<b>1115006</b>	4' & 5' ClassMate	6.0 lbs. (2.7 kg)

Hood Width	3'				4'				5'			
Interior Hood Depth*	24"	30"	36"	48"	24"	30"	36"	48"	24"	30"	36"	48"
Required Quantity	1	1	1	1	1	1	1	1	1	1	1	1

Hood Width	6'				7'				8'			
Interior Hood Depth*	24"	30"	36"	48"	24"	30"	36"	48"	24"	30"	36"	48"
Required Quantity	1	1	1	2	1	1	2	2	1	2	2	2

Hood Width	10'				12'				16'			
Interior Hood Depth*	24"	30"	36"	48"	24"	30"	36"	48"	24"	30"	36"	48"
Required Quantity	2	2	2	3	2	2	2	3	2	3	3	4

\*Round up if exact dimension is not shown.  
 \*\*UL® is a registered trademark of UL LLC.

# Fume Hood Accessories

**3-Sided Ceiling Enclosure Kits.** Panels extend above the top of the hood to the ceiling to hide exposed ductwork, plumbing and wiring. Each kit includes three glacier white powder-coated steel panels. Contact Labconco about other heights.

## Catalog Number Configurator:

Use this key to configure the seven digit catalog number to order your 3-Sided Adjustable Ceiling Enclosure Kit.

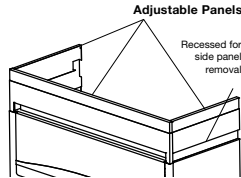

## Catalog Number Configurator:

Use this key to configure the seven digit catalog number to order your 3-Sided Non-Adjustable Ceiling Enclosure Kit.

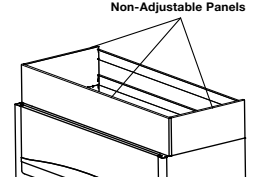

9 4 1 4

Select the **NOMINAL WIDTH** of your fume hood. This is the fifth digit of your catalog number.

**3** = 3'      **4** = 4'      **5** = 5'  
**6** = 6'      **7** = 7'      **8** = 8'

Select the **EXTERIOR DEPTH** of your fume hood. This is the sixth digit of your catalog number.

**0** = 31.7"      **1** = 37.7"\*      **2** = 43.7"\*

Select the **HEIGHT RANGE**. Should match the height between the top of the hood and building ceiling. This is the seventh digit of your catalog number.

**0** = 11-14"      **1** = 14-18.6"      **2** = 18.6-24.4"

9 5 5 0

Select the **NOMINAL WIDTH** of your fume hood. This is the fifth digit of your catalog number.

**3** = 3'      **4** = 4'      **5** = 5'  
**6** = 6'      **7** = 7'      **8** = 8'

Select the **EXTERIOR DEPTH** of your fume hood. This is the sixth digit of your catalog number.

**0** = 31.7"      **1** = 37.7"\*      **2** = 43.7"

Select the **EXACT HEIGHT**. Should match the height between the top of the hood and slightly below building ceiling. This is the seventh digit of your catalog number.

**0** = 6"      **1** = 12"      **2** = 18"  
**3** = 24"      **4** = 30"      **5** = 36"

**Rear Finish Panel Kits.** Hide the hood's interior components. Include a glacier white powder-coated steel panel.

Catalog Number	Nominal Width	Width x Height	For use with Protector Hood	Shipping Weight
9419300	3'	36.0" x 59.0"	XL Benchtop	53 lbs. (24 kg)
9419400	4'	48.0" x 59.0"	XL Benchtop, Premier, XStream, Stainless Steel, PVC	70 lbs. (32 kg)
9419500	5'	60.0" x 59.0"	XL Benchtop, Premier, XStream, Stainless Steel, PVC	80 lbs. (36 kg)
9419600	6'	72.0" x 59.0"	XL Benchtop, Premier, XStream, Stainless Steel, PVC	90 lbs. (41 kg)
9419700	7'	84.0" x 59.0"	XL Benchtop	108 lbs. (49 kg)
9419800	8'	96.0" x 59.0"	XL Benchtop, Premier, XStream, Stainless Steel, PVC	120 lbs. (54 kg)
9562700	4'	38.0" x 95.0"	ClassMate	20 lbs. (9 kg)
9562701	5'	50.0" x 95.0"	ClassMate	25 lbs. (12 kg)
9562702	6'	62.0" x 95.0"	ClassMate	30 lbs. (14 kg)
9548400**	4'	48.0" x 95.0"	XL Floor-Mounted	112 lbs. (50 kg)
9548500**	5'	60.0" x 95.0"	XL Floor-Mounted	129 lbs. (58 kg)
9548600**	6'	72.0" x 95.0"	XL Floor-Mounted	145 lbs. (65 kg)
9548800**	8'	96.0" x 95.0"	XL Floor-Mounted	193 lbs. (87 kg)

\*9548700 Ceiling Enclosure Conversion Kit is required for Protector XL Floor-Mounted Hoods. Order separately.

\*\*Adding a Rear Finish Panel to a Protector XL Floor-Mounted Hood increases the external depth of the hood by 1.5".

# Fume Hood Accessories



**Guardian™ Airflow Monitors.** Sense and alert the operator to low airflow conditions. From the monitor's face plate, the user can easily select and calibrate a set point between 30 and 250 fpm using user-supplied velocity meter and screwdriver. Audible/visual alarm. Includes external alarm and alarm mute functions. Flush-mount design. **Requires field calibration.**

Catalog Number	Electrical Requirements	For Use With Protector Hood	Shipping Weight
9413300	100-115V, 50/60 Hz	Premier, XStream, XL, Stainless Steel, PVC	6.0 lbs. (2.7 kg)
9413301*	208-230V, 50/60 Hz	Premier, XStream, XL, Stainless Steel, PVC	6.0 lbs. (2.7 kg)

**Tissue Screen Kits.** Screen mounts behind the baffles for trapping tissues and other papers. Include mounting hardware, powder-coated stainless steel screen and instructions.

Catalog Number	Nominal Width	For use with Protector Hood	Shipping Weight
9576710	3'	XL	3.0 lbs. (1.4 kg)
9576711	4'	XL	4.0 lbs. (1.8 kg)
9576712	5'	XL	5.0 lbs. (2.3 kg)
9576713	6'	XL	6.0 lbs. (2.7 kg)
9576714	7'	XL	7.0 lbs. (3.2 kg)
9576715	8'	XL	8.0 lbs. (3.8 kg)
9576910	4'	XStream	4.0 lbs. (1.8 kg)
9576911	5'	XStream	5.0 lbs. (2.3 kg)
9576912	6'	XStream	6.0 lbs. (2.7 kg)
9576913	8'	XStream	8.0 lbs. (3.8 kg)
9577110	4'	Premier	4.0 lbs. (1.8 kg)
9577111	5'	Premier	5.0 lbs. (2.3 kg)
9577112	6'	Premier	6.0 lbs. (2.7 kg)
9577113	8'	Premier	8.0 lbs. (3.8 kg)



**Guardian™ Digital Airflow Monitors.** Sense and alert the operator to low airflow conditions. Display actual airflow in fpm or m/sec. Audible/visual alarm alerts user to sustained low velocity condition. LCD displays calibration instructions. Include airflow sensor, external alarm and mute functions. Contact Labconco for optional RS-485 port for Modbus\*\* RTU communication and temperature sensor. Flush-mount design. **Requires field calibration.**

Catalog Number	Electrical Requirements	For Use With Protector Hood	Shipping Weight
9413400	100-115V, 50/60 Hz	Premier, XStream, XL, PVC, ClassMate, Stainless Steel	6.0 lbs. (2.7 kg)
9413401*	208-230V, 50/60 Hz	Premier, XStream, XL, PVC, ClassMate, Stainless Steel	6.0 lbs. (2.7 kg)

**7117700—Airflow Monitor Cable.** Pre-configured cable for use with minimum setting on Intelli-Sense Blower that sends an input signal to the Guardian Digital Airflow monitor for night setback.

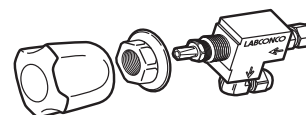

**9808310—Washdown Valve Kit.** For mounting on either side of any Perchloric Acid or Acid Digestion Hood. Provides water for up to three wash rings (sold separately). Field-installed kit includes one remotely-controlled fixture with brass valve and green fixture knob. Designed for 0.375" dia. copper tubing. **Inlet and outlet tubing is not included.** Maximum flow rate is 3 GPM. Recommended working pressure is 40 psi. Shipping weight 4.0 lbs. (1.8 kg)

**4852600—Side-Mount Oval Polypropylene Cupsink.** Mounts on side wall of Protector XL Floor-Mounted Hoods. 6.0" x 3.0" (15.2 x 7.6 cm) cupsink. 1.5" NPSM\* thread. **Requires 1.875" dia. drill hole in liner.** Shipping weight 4.0 lbs. (1.8 kg)



\*International electrical configuration

\*\*Modbus is a registered trademark of Schneider Automation.

# Everything you need to succeed.

## Ventilated Enclosures & Exhausters

Fume Hoods & Enclosures  
Filtered Fume Hoods  
Ductless (Carbon-Filtered) Enclosures  
Biological Safety Cabinets & Enclosures  
Clean Benches  
PCR Enclosures  
Balance, Bulk Powder & Equipment Enclosures  
Nanotechnology Enclosures  
Laboratory Animal Research Stations  
Non-ventilated Enclosures  
Remote Blowers & Exhausters

## Sample Preparation Equipment

Freeze Dryers  
Nitrogen Blow Down Dry Evaporators  
Vacuum Dry Evaporators  
Vacuum Concentrators  
Cold Traps  
Vacuum Pumps

## Glassware Washers

## Water Purification Systems

## Glove Boxes & Gas Purifiers

Controlled Atmosphere Glove Boxes  
Filtered Glove Boxes  
Combination Glove Boxes

## Forensic Enclosures

## Kjeldahl, Fat & Crude Fiber Apparatus

## Other Products

Laboratory Carts, Tables & Benches  
Blood Drawing Chairs  
Vacuum Desiccator  
Base Stands, Base Cabinets & Work Surfaces  
Filters & Prefilters  
Vacuum Pumps  
Freeze Dryer Accessories  
Ventilation Product Accessories



Visit [labconco.com](https://labconco.com) to request information for all Labconco products.

## LABCONCO CORPORATION

8811 Prospect Avenue  
Kansas City, MO 64132

(800) 821-5525 | (816) 333-8811

[labconco.com](https://labconco.com)

©2024 LABCONCO CORPORATION

Printed in the U.S.A.

Product design subject to change without notice.

2-61-5/24/24

**LABCONCO**<sup>®</sup>